



DOWNTOWN INDIANAPOLIS





INDIANA CONVENTION CENTER - LEVEL 1

100 S Capitol Ave, Indianapolis, IN 46225





INDIANA CONVENTION CENTER - LEVEL 2

100 S Capitol Ave, Indianapolis, IN 46225

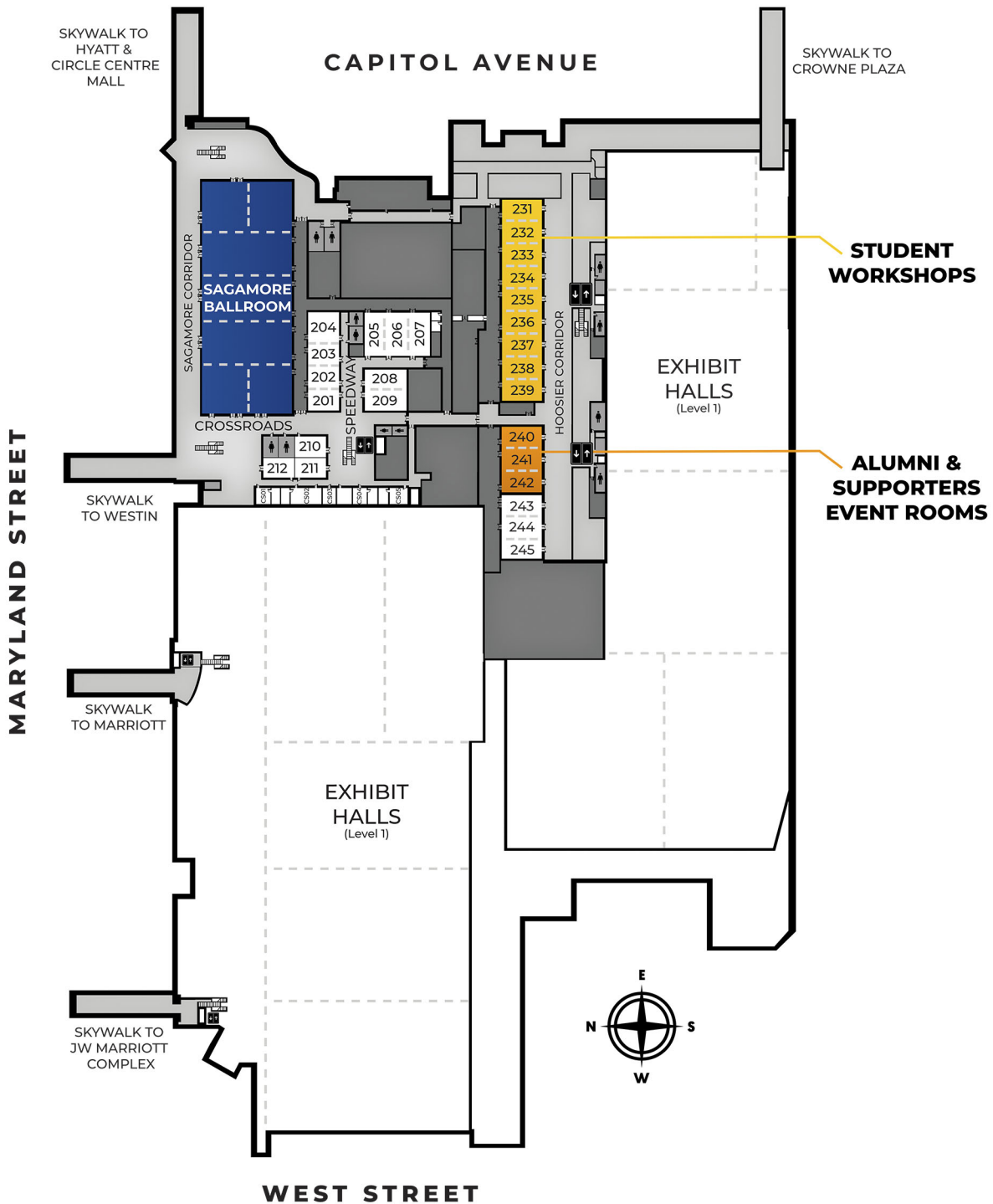



LUCAS OIL STADIUM

500 S. Capitol Ave., Indianapolis, IN 46225

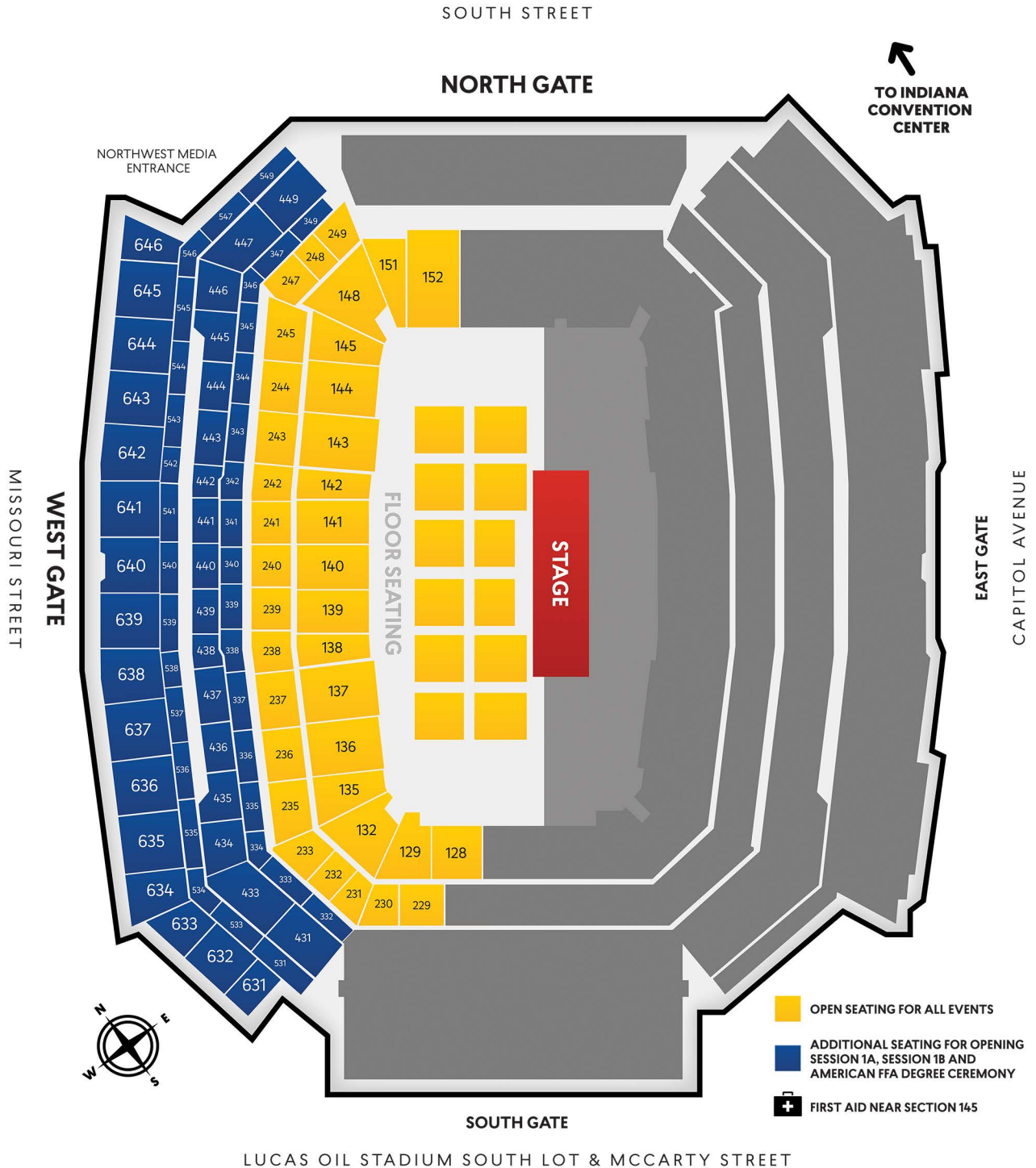

- OPEN SEATING FOR ALL EVENTS
- ADDITIONAL SEATING FOR OPENING SESSION 1A, SESSION 1B AND AMERICAN FFA DEGREE CEREMONY
- + FIRST AID NEAR SECTION 145

LUCAS OIL STADIUM SOUTH LOT & MCCARTY STREET



GAINBRIDGE FIELDHOUSE

125 S. Pennsylvania St., Indianapolis, IN 46204
(formerly Bankers Life Fieldhouse)

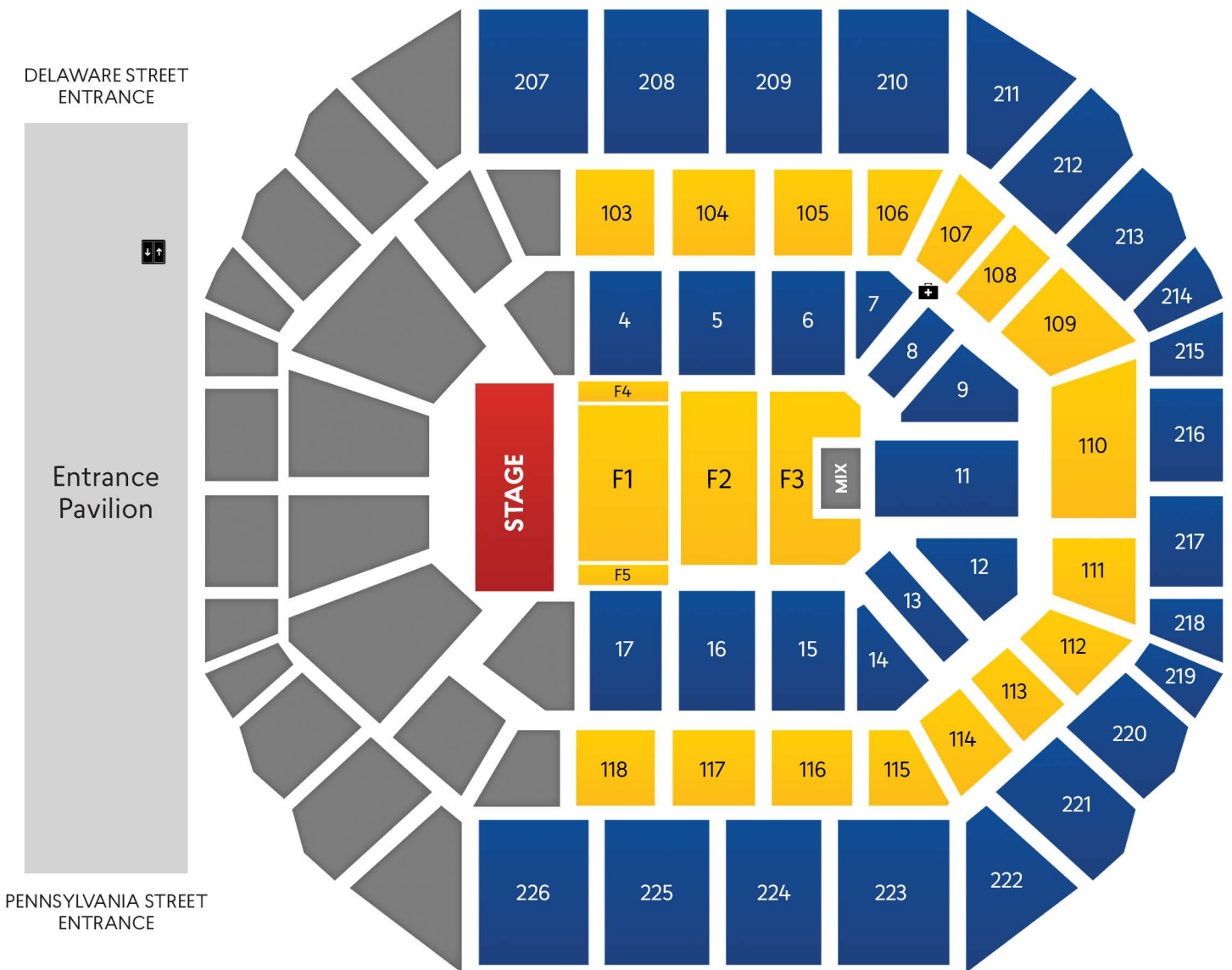

↓ TO INDIANA CONVENTION CENTER



-  ELEVATOR
-  FIRST AID IS LOCATED ON THE MAIN CONCOURSE NEAR SECTION 7



INDIANA FARMERS COLISEUM

1202 E 38th St., Indianapolis, IN 46205





INDIANA STATE FAIRGROUNDS

1202 E. 38th St., Indianapolis, IN 46205

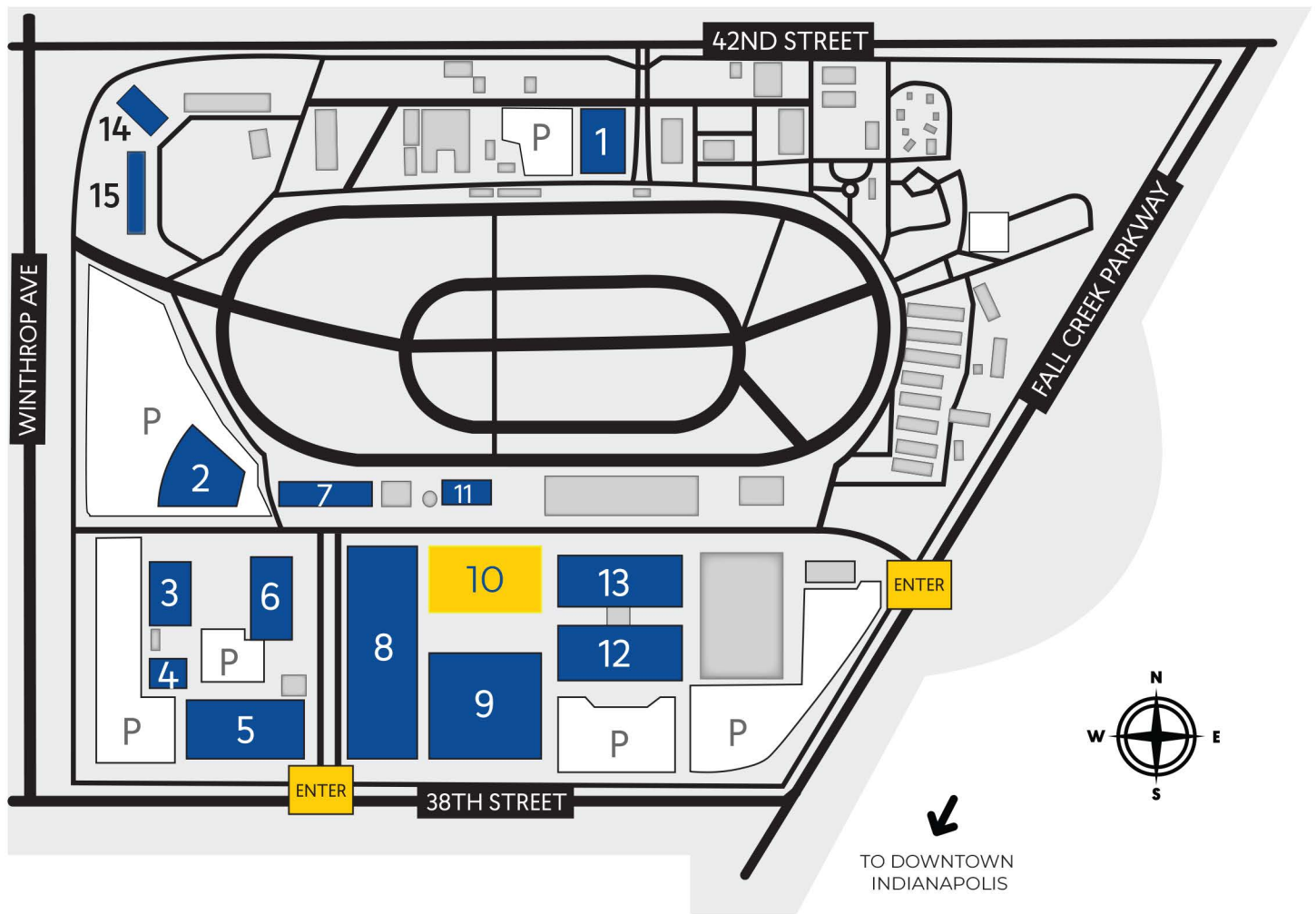

- | | |
|--------------------------------------|---------------------------------------------|
| 1. Indiana Farm Bureau Building | 9. South Pavilion |
| 2. Agriculture Horticulture Building | 10. Indiana Farmers Coliseum |
| 3. Northwest Pavilion | 11. Grand Hall |
| 4. Southwest Pavilion | 12. Elements Financial Blue Ribbon Pavilion |
| 5. Exposition Hall | 13. Champions Pavilion |
| 6. Indiana Arts Pavilion | 14. 4-H Exhibit Hall |
| 7. Harvest Pavilion | 15. Centennial Hall |
| 8. West Pavilion | |

CDE and Rodeo Shuttles (passes required) to/from Indiana Convention Center will load/unload near West Pavilion (8).
Off-site CDE shuttles load/unload near Indiana Arts Pavilion (6).



NATIONAL FFA EXPO & SHOPPING MALL

100 S Capitol Ave, Indianapolis, IN 46225

